



PSZCZOŁY
PROSZĄ O POMOC



Fundacja Ekologiczna
ZIELONA AKCJA

Good practice 6



Creation of nectariferous zones



Legnica 2015



Fundacja Ekologiczna
ZIELONA AKCJA

Bees ask for help - a campaign to protect the living environment of bees and other pollinators financed within the framework of the Financial Mechanism 2009-2014 EEA and Norwegian Financial Mechanism 2009-2014.





Creation of nectariferous zones

Helpful insects, especially wild pollinators feel the negative changes that occur in our environment. More than half of the species of bees and butterflies are threatened with extinction. How can we help these animals?

One way to improve their fate is to create a friendly greenery for bees. Instead of the ubiquitous conifers, trimmed lawns and „sterile” graveled flowerbeds should be planted flowering plants, composed in the natural composition which will become a refuge for bees, butterflies and birds. Such specific nectariferous plants zones are not only a valuable food source for beneficial animals but also look beautiful.

The idea of creating a friendly greenery for bees became the basis of the project „Bees are asking for help”, realized together with the inhabitants of several villages by the Ecological Foundation „Zielona Akcja” (“Green Action”).

One such a village was located in the municipality Prusice - village Strupina. Thanks to the involvement of residents in the central square, as well as around the school appeared surrounded by lavender, cotoneaster and boxwood flower beds of roses. The selection of these plants was not accidental but associated with the idea of promoting the town as a rose village.

One such a village was located in the municipality Prusice - village Strupina. Thanks to the involvement of residents in the central square, as well as around the school appeared surrounded by lavender, cotoneaster and boxwood flower beds of roses. The selection of these plants was not accidental but associated with the idea of promoting the town as a rose village.

In case of the design of any green you should consider:

- The function that should meet (natural, educational, aesthetic, social, safety, etc.),
- Habitat conditions and climate,
- Character of a place - whether it is a village or a small town or perhaps a large metropolitan area,
- Historical context, local traditions, materials, etc.
- Comfort of use,
- Available funds.

Seedlings were delivered at the end of April. Dozens of residents participated in the plantings. By joining forces managed to plant a lot of plants which bloomed profusely in the same year.

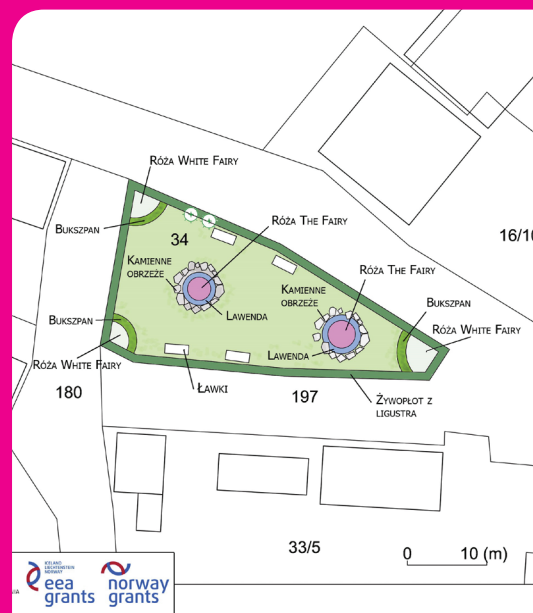

Find us on facebook:
Pszczółki proszą o pomoc

Copyright:
Fundacja Ekologiczna „Zielona Akcja”, ul. Orła Białego 2, 59-220 Legnica
tel. (76) 862 94 30, (76) 723 81 01; fax (76) 721 24 96
<http://www.zielonaakcja.pl>

